

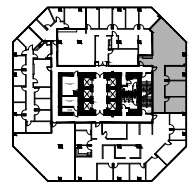

**SUITE 1210**

1,997 RSF

May 19, 2022



KEY PLAN  
SCALE: N.T.S.

 BAHAREA LARSEN  
blarsen@feldmanequities.com  
KELLEY IAQUINTA  
kiaquinta@feldmanequities.com  
813-579-3934

**FIRST CENTRAL TOWER**

360 CENTRAL AVENUE, ST. PETERSBURG, FLORIDA 33701

**CMK Design Studio, Inc.**  
Planning & Design of the Built Environment

6822 22nd Ave. N. #148  
St. Petersburg, Florida 33710  
Ph: 727.515.8461

LIC NO: AA26002603