

**SUITE 1225**  
1,727 RSF

January 5, 2021

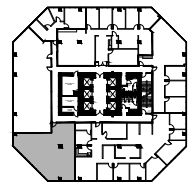

KEY PLAN  
SCALE: N.T.S.

**F** BAHAREA LARSEN  
blarsen@feldmanequities.com  
CECI TRICOLI  
ctricoli@feldmanequities.com  
727-565-0316 x 107

**FIRST CENTRAL TOWER**  
360 CENTRAL AVENUE, ST. PETERSBURG, FLORIDA 33701

**CMK Design Studio, Inc.**  
Planning & Design of the Built Environment  
6822 22nd Ave. N. #148  
St. Petersburg, Florida 33710  
Ph: 727.515.8461

LIC NO: AA26002603